

DD 59 A

AREA PLANNING III

AREA STATEMENT

1 TOTAL AREA OF THE SCHEME	50479.00 SM / 5.048 HAC
2 AREA UNDER CONVENIENT SHOPPING	1903.00 " 0.19 HAC.
3 AREA UNDER FIRE STATION	3680.00 " 0.368 "
4 AREA UNDER H.S.S.	11152.00 " 1.115 "
5 AREA UNDER PARK/TOT LOT	3433.00 " 0.343 "
[PLOTS/AREA AFFECTED BY F.S.]	
1 TO 8, PARTLY 9 NO. PLOT, 152 TO 167 AND SERVICE LANE, PART 174-180	0.37 "
6 AREA UNDER ROADS/CIRCULATIONS	10303.00 " 1.03 "
TOTAL AREA	50479.00 SM / 5.048 HAC.

TOTAL PLOTS : 260 NOS. [PH. I: 186 + PH. II: 82]
 PLOTS FALLING UNDER VIDYA BHARTI SCHOOL & C. 146-184 NOS. HAVE BEEN DELETED. THESE NOS. HAVE BEEN ALLOTTED TO OTHER RES. PLOTS TO MAINTAIN NUMBERING.

- NOTES**
- THIS DRAWING IS TRACED FROM THE DRAWING SUPPLIED BY THE EXECUTIVE ENGINEER WD-1
 - EXISTING PORTION SHOWN THUS
 - ENCROACHMENT PORTION SHOWN THUS
 - PROPOSAL OF PHASE I (F. APPROVAL) SHOWN THUS
 - NO. OF PLOTS ENCROACHED UNAUTHORISEDLY BY TEMPLE ARE FROM 25 TO 32 AND PLOT NO. 10, 9A, PART OF PLOT NO. 8 & 9
 - SCHEME BOUNDARY SHOWN THUS
 - PHASE II NOT CONSIDERED FOR APPROVAL SHOWN THUS
 - IT FALLS UNDER DEVELOPMENT AREA NO. 88 & 117
 - PLOTS AUCTIONED SHOWN THUS (AS INFORMED BY DY. DIR. O.S.B.)
- DETAIL OF PLOTS :-**

CATEGORY OF PLOTS

A	B	B-1
20'-0" x 4'-5" (100 Sq. Yds.)	16'-0" x 5'-0" (80 Sq. Yds.)	18'-0" x 40'-0" (80 Sq. Yds.)
PLOTS CONSIDERED FOR APPROVAL IN PHASE - 1		
11-16, 18, 19-24, 33, 34	199-205, 206-217, 35-39, 41-46, 47-51, 71-75, 76-85	168-170, 171-173, 161-190
06-07, 98-106, 107-114, 115-122, 123-134, 135-142, 143-151, 191-198		

PLOTS AFFECTED BY EXISTING FIRE STATION
 1-9, 152-160, 161-167, [A-15 + B-3] TOTAL - 82

PLOTS AFFECTED BY TEMPLE
 8, 9 & 9A (PART), 30, 31, 32, 33, 34

PLOTS AFFECTED BY VIDYA BHARTI SCHOOL
 146-154, 155-164, 165-173 & 174-184 [TOTAL 39]

A [30' x 45' = 100 Sq. Yds.] 52-70
 B [18' x 40' = 80 Sq. Yds.] 174-180

LAND DEVELOPMENT FOR OCCUPANTS AFFECTED BY SHANKAR ROAD WIDENING [PHASE - 1]

LAYOUT PLAN

SCALE: 1:50 FT	DATE: 17.10.97	DIR-AP III/10/97/2
PLG. DRAFTSMAN	PLG. ASST	ASST. DIRECTOR
JT. DIRECTOR	DIRECTOR (AP III)	PL. COMM. (AP)

योजना क्षेत्र III
 दिल्ली विकास प्राधिकरण

NOTES:-
 EXFACTO APPROVAL OF COMM. PLG./ VC. DDA HAS BEEN OBTAINED ON 13.11.97 IN FILE NO. PA/3D/AP/II/97. FOR PHASE-I ONLY.

STATEMENT OF RESIDENTIAL PLOTS FROM PLOT NOS. 52 TO 68 FOR PHASE-II

PLOT NO.	SIZE	AREA (APPROX.)	REMARKS
52	21'-6" x 42'-0" = 908.72 SQ. YDS.	100.32	SUBJECT TO
53 TO 63	21'-0" x 42'-0" = 882.00 SQ. YDS.	98.00	FEASIBILITY CHECK-UP AT SITE
64	20'-6" x 42'-0" = 864.00 SQ. YDS.	95.66	
65 TO 68	SUBJECT TO AVAILABILITY OF LAND ENCROACHED BY FISH SHOPS		

THE SCHEME OF RESIDENTIAL PLOTS BEARING NO. 52 TO 64 PHASE II (PART) HAS BEEN APPROVED IN 234 H. SCREENING COMMITTEE MEETING HELD ON 24-3-04 VIDE ITEM NO. 158: 2004 IN FILE NO. F3(13)/RP/CC-5/98-VOL-II/303 AT PAGE NO. 37/H

PLG. D/MAN PLG. ASST. ASST. DIR. DY. DIR. (AP-I)

ENCROACHMENT BY THE FISH SHOPS. (PLOT NO. 65 TO 68)

TEMPLE ENCROACHED/CONSTRUCTED UNAUTHORISEDLY

THIS NOTE IS NO MORE VALID IN VIEW OF DECISION OF 234 H SCREENING COMMITTEE MEETING HELD ON 24-3-04 VIDE ITEM 158: 2004

DEVELOPMENT AUTHORITY HOPW-COORDINATION UNIT VERIFIED

THIS PROPOSAL WAS CONSIDERED IN THE 234 H SCREENING COMMITTEE MEETING HELD ON 4-10-04 VIDE ITEM NO. 114: 2004

BY DIRECTOR (AP III)

KEY PLAN
 SCALE: 1" = 500'

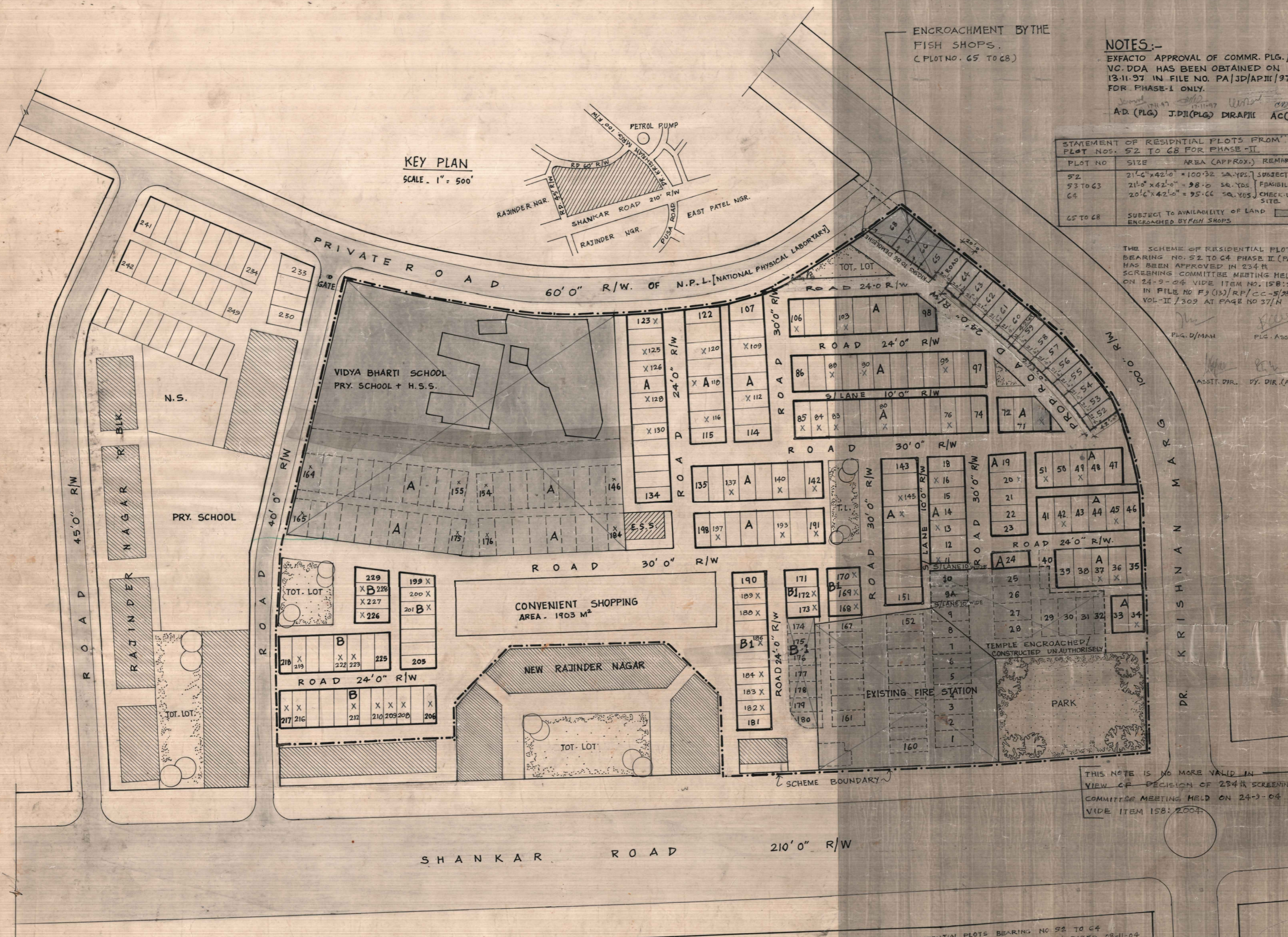
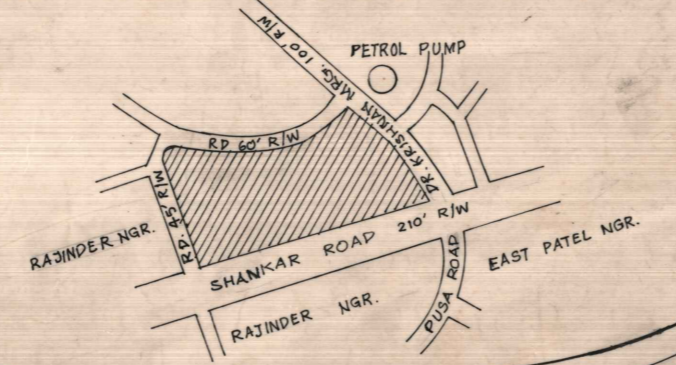

THE SCHEME OF RESIDENTIAL PLOTS BEARING NO. 52 TO 64 PH. II (PART) HAS BEEN AUTHENTICATED BY DIR. (AP I) DATED 08-11-04 AND VERIFIED BY DIR. (ARCH) COORH. DATED 22-11-04 IN FILE NO. F3(13)/RP/CC-5/98/VOL-II/303

BY DIRECTOR (AP-I)